

S36/S36SC – PRO POSUVNÉ SKŘÍŇOVÉ DVEŘE

Montáž brzdy
– namontujte před nasazením lišty

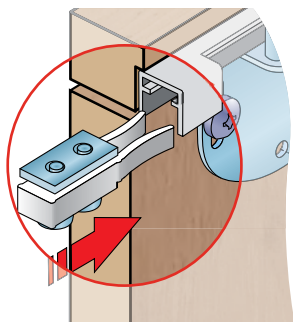

Možnost seřízení
horního vozíku

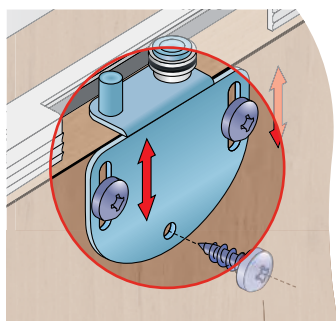

Možnost seřízení
dolního vozíku

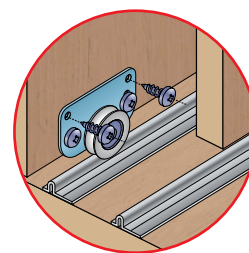
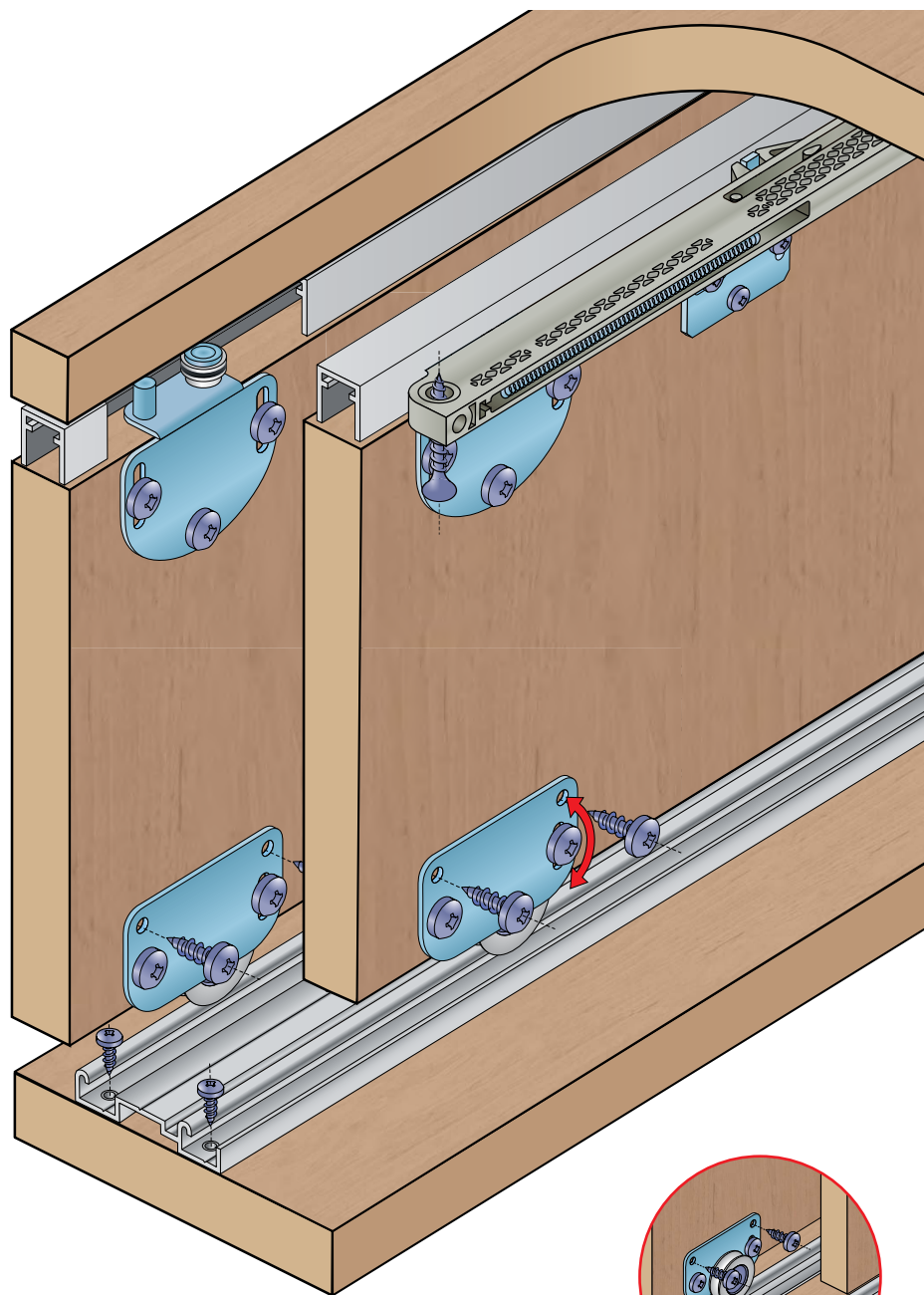
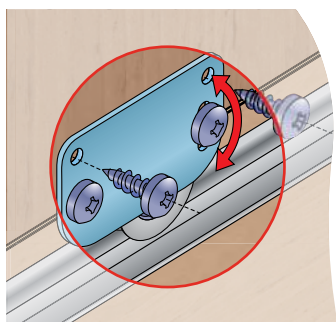

SOUČÁSTI SYSTÉMU:

Sada S36

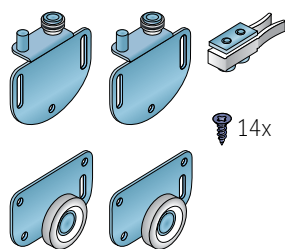

13C0S36

Sada S36 SC

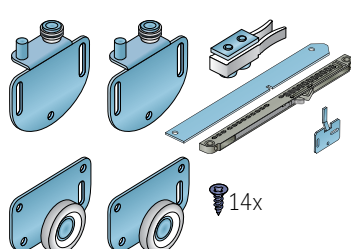

13C0S36SC25
13C0S36SC40

PROFILY:

Profil S50 dolní

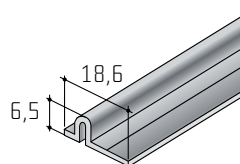

13D1S50DXX [elox]
13D2S50DXX [suravý]

Profil S50 horní

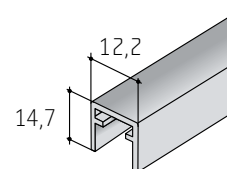

13D1HP50XX [elox]
13D2HP50XX [suravý]



tlumič
Softclose



35 kg



kuličkové
ložisko



min.
18 mm



spodní
vedení

NÁBYTKOVÉ KOVÁNÍ

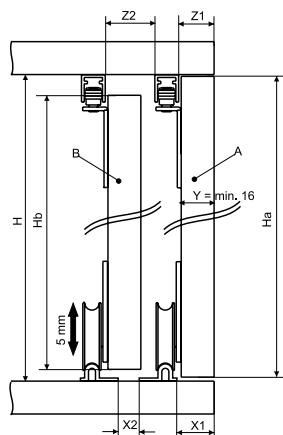

$$\begin{aligned} H_a &= H - \text{min. } 4 \\ H_b &= H - 20 \\ X_1 &= Y + 3 \\ X_2 &= Y - 13,5 \\ Z_1 &= Y + 4 \\ Z_2 &= Y + 5 \end{aligned}$$

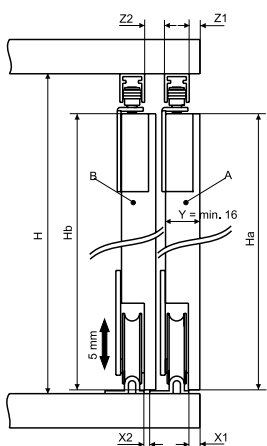
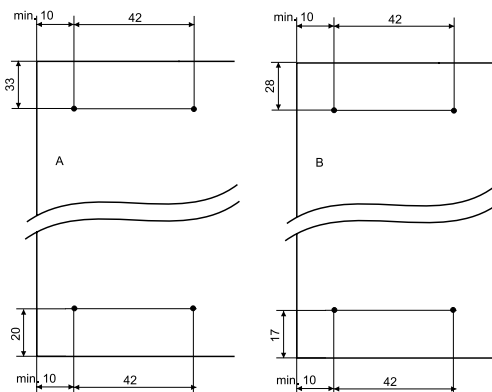

$$\begin{aligned} H_a &= H_b = H - \text{min. } 20 \\ X_1 &= Y - 12 \\ X_2 &= Y - 12,5 \\ Z_1 &= Y - 13,5 \\ Z_2 &= Y - 5 \end{aligned}$$

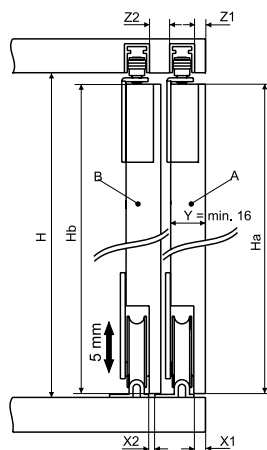
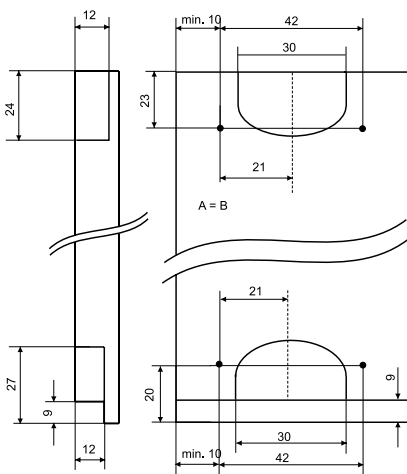

$$\begin{aligned} H_a &= H_b = H - \text{min. } 4 \\ X_1 &= Y - 12 \\ X_2 &= Y - 12,5 \\ Z_1 &= Y - 13,5 \\ Z_2 &= Y - 5 \end{aligned}$$

Montáž dveří

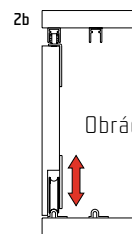
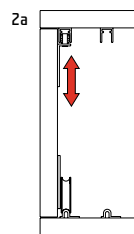
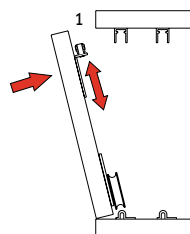

Obrácená verze

1. V prvním kroku se zašroubují vozíky na dveře. Dále je třeba spustit horní vozík, aby bylo možno zasunout dveře s vozíky do dolních lišt.

2. Po umístění dveří s vozíky do dolních lišt se zvedne horní vozík do horní lišty a po výškovém nastavení se zařazuje v požadované poloze pomocí zajišťovacích šroubů.

Profil S06

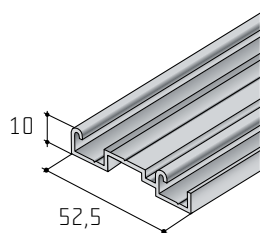

17D1DS06XX

Profil S50 horní pro zařezování

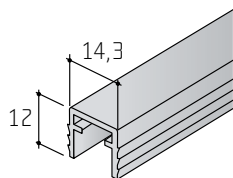

13D2HF50XX

Brzda S27AL/S37AL/S36/S37/S60H

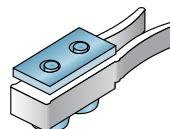

13C0S36B

Softclose S36/S37 Slidix

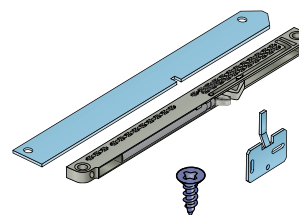

17C03625
17C03640